

RCF

KITS

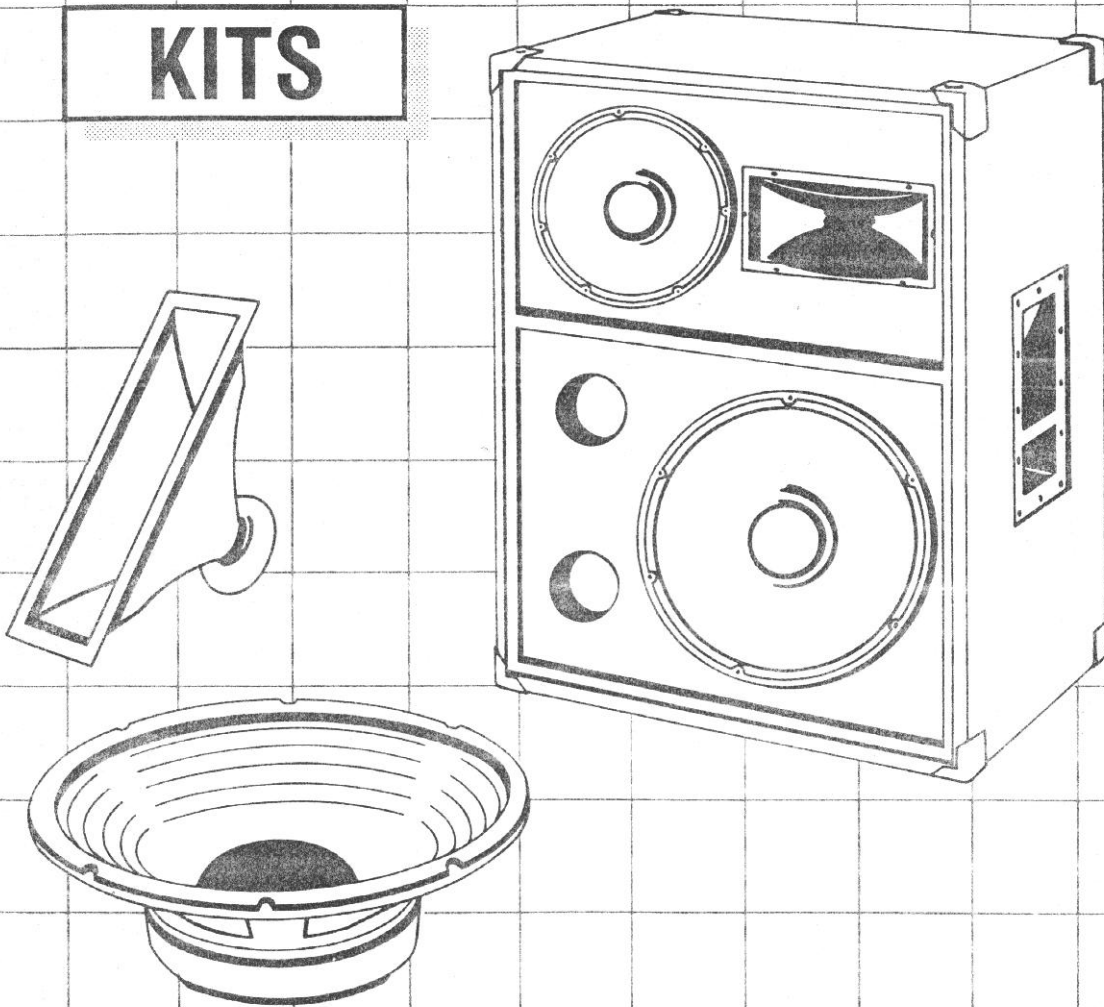

SYSTEM DESIGN MANUAL

INTRODUCTION

The purpose of presenting the system designs of this manual is that of offering the expertise of RCF engineers avoiding you to be forced in going through long and extensive research.

Specific needs of the professional musician and sound reinforcement are covered. The designs have been developed using advanced analysis methods and theories and are based on some of the most interesting drivers in the RCF line.

CABINET CONSTRUCTION

- Type of wood: We recommend the use of plywood. Chipboard can be damaged in transport and is more sensitive to humidity.
- Make sure that all joints are perfectly airtight. Do not hesitate to use a lot of glue to make joints hermetically sealed.
- Make use of cross braces when assembling the cabinet to minimize vibrations. This is essential in large surface areas. Use the technique of glue plus screw to assure better resistance.
- Any hole in the cabinet other than the vent area should be airtight. Be sure to check airtightness of handles.
- Cover internal walls of cabinet with glass fiber with exception of high frequency section.

LOUDSPEAKER MOUNTING

- The cabinet drawings foresee the front mounting of the speakers.
- Speakers should be tightly secured preferably with nuts and bolts.
- To assure airtightness between speaker and cabinet a foam gasket should be used.

CROSSOVER NETWORKS

The recommended crossover networks should be used as part of the system design.

KIT 200

SPECIFICATIONS

FREQUENCY RESPONSE: 60 ÷ 19000 Hz

SENSITIVITY: 98 dB

POWER HANDLING:
200 W AES/100 W sine wave

MAXIMUM SPL: 122 dB

CROSSOVER FREQUENCY:
4000 Hz

IMPEDANCE: 8 Ohms

MAXIM. RECOMM. AMPLIF. POWER:
150 W

COMPONENTS: L12C X 2 Coaxial
full range

CROSSOVER: FT 200

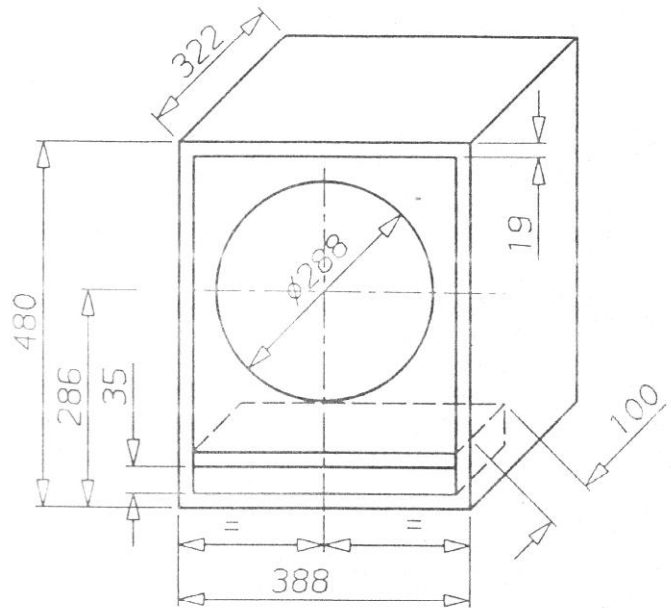

CONSTRUCTION NOTES

- Place glass fiber inside cabinet

CROSSOVER CONNECTION

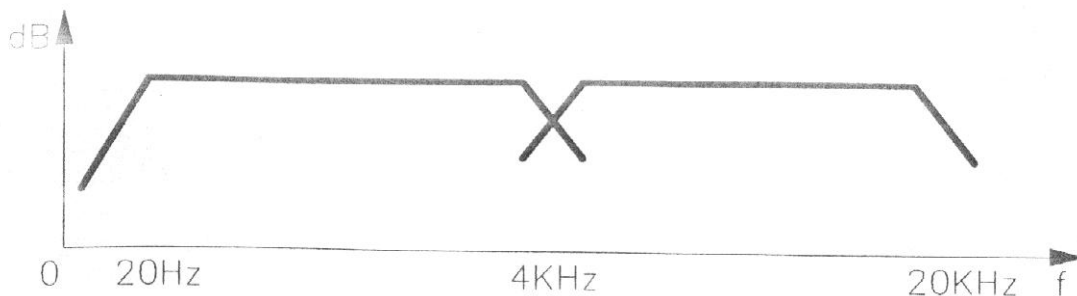
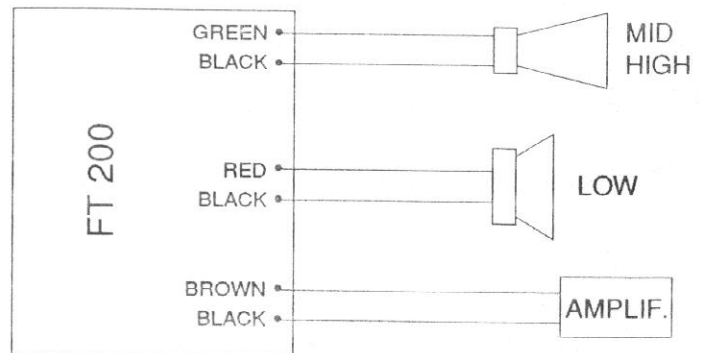

KIT 250 KIT 250 S

SPECIFICATIONS

FREQUENCY RESPONSE: 40 ÷ 20000 Hz

SENSITIVITY: 100 dB

POWER HANDLING:
250 W AES/125 W sine wave

MAXIMUM SPL: 124 dB

CROSSOVER FREQUENCY: 4000 Hz

NOMINAL IMPEDANCE: 8 Ohms

MAXIM. RECOMM. AMPLIF. POWER:
150 W

COMPONENTS: L.F. L12/565
H.F. N 252

CROSSOVER: FT 250

CONSTRUCTION NOTES

- Place glass fiber inside cabinet

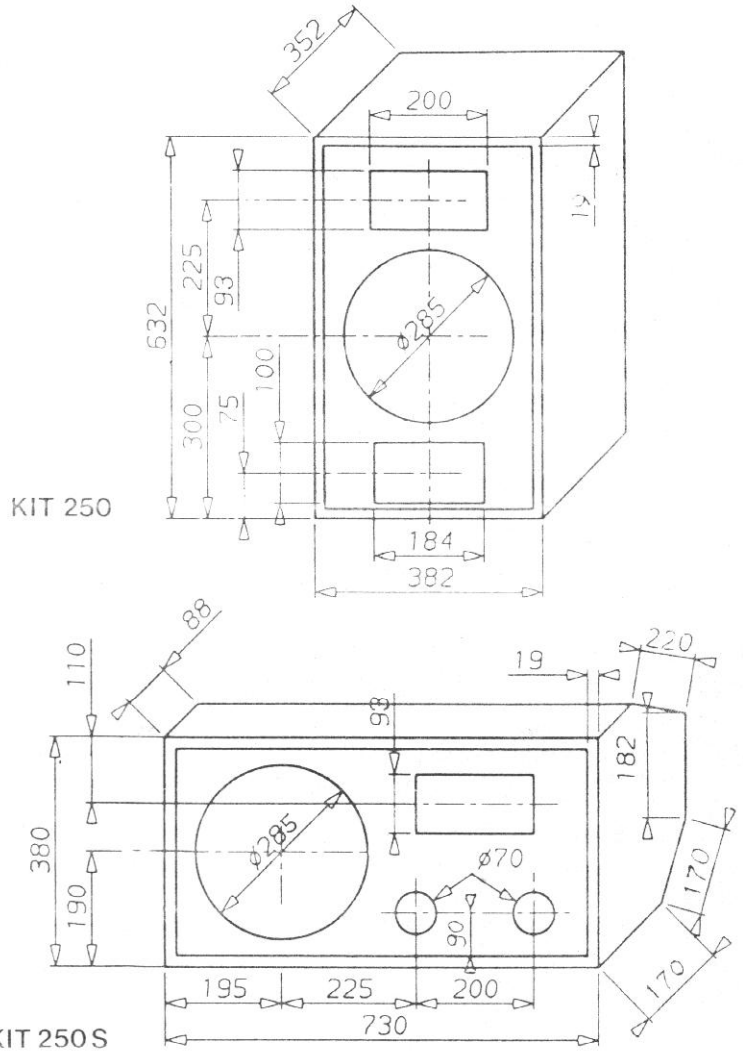

CROSSOVER CONNECTION

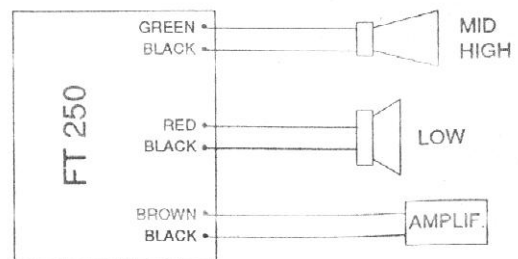
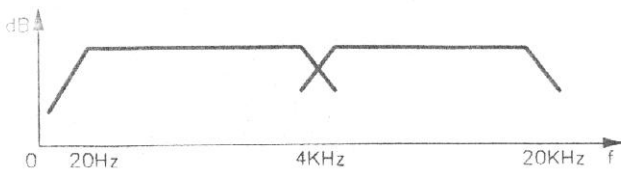

KIT 450

SPECIFICATIONS

FREQUENCY RESPONSE: 45 ÷ 20000 Hz

SENSITIVITY: 99 dB

POWER HANDLING:
450 W AES/275 W sine wave

MAXIMUM SPL: 125 dB

CROSSOVER FREQUENCY: 4000 Hz

NOMINAL IMPEDANCE: 8 Ohms

MAXIM. RECOMM. AMPLIF. POWER:
300 W

COMPONENTS: L.F. L15/554K
H.F. TW 116 or N681/H9041
with 3 dB attenuator

CROSSOVER: FT 450

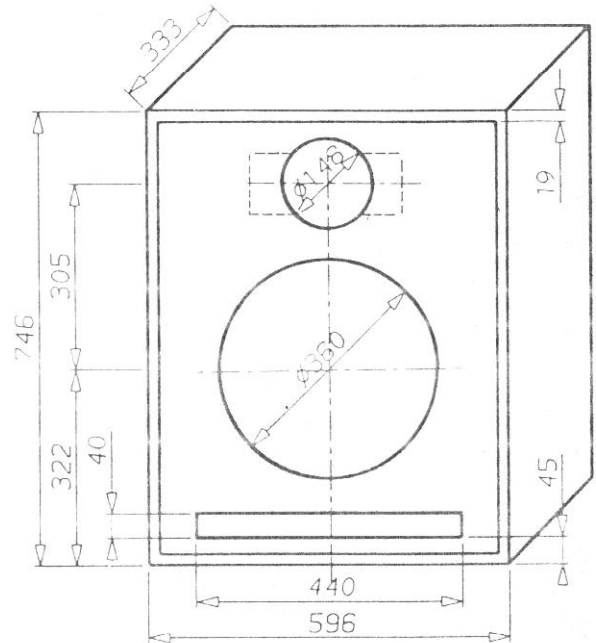

CONSTRUCTION NOTES

- Place glass fiber inside cabinet
- Use cross braces against vibrations

CROSSOVER CONNECTION

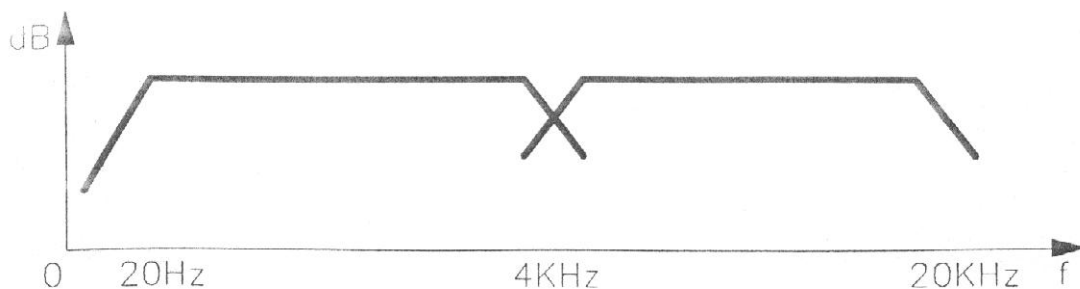
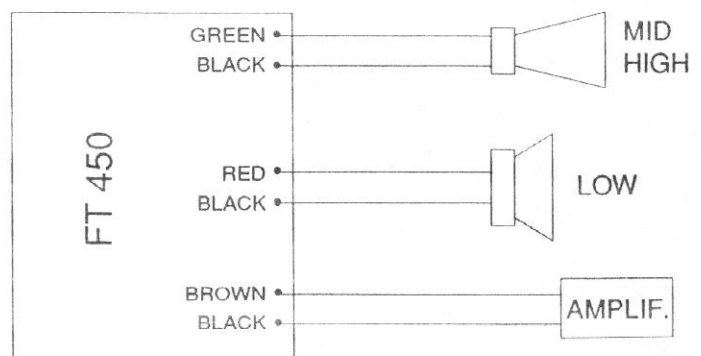

KIT 500

SPECIFICATIONS

FREQUENCY RESPONSE: 30 ÷ 20000 Hz

SENSITIVITY: 100 dB

POWER HANDLING:
500 W AES/250 W sine wave

MAXIMUM SPL: 127 dB

CROSSOVER FREQUENCIES:
350 ÷ 5000 Hz

IMPEDANCE: 8 Ohms

MAXIM. RECOMM. AMPLIF. POWER:
300 W

COMPONENTS:
L.F. L15/542K
M.F. L10/561
H.F. N 252

CROSSOVER: FT 500

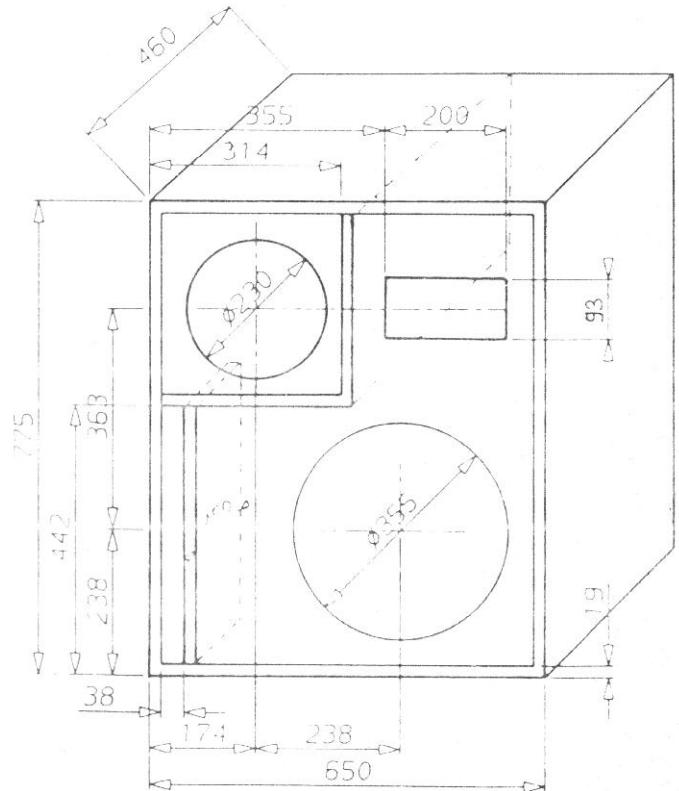

CONSTRUCTION NOTES

- Check airtightness of mid cabinet and place glass fiber inside
- Use cross braces against vibrations

CROSSOVER CONNECTION

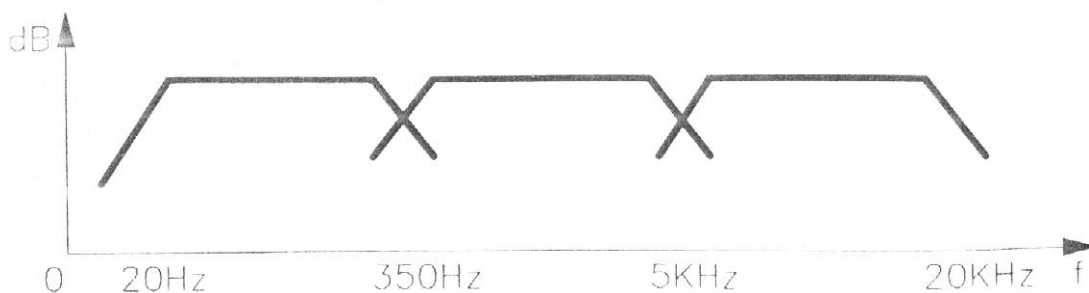
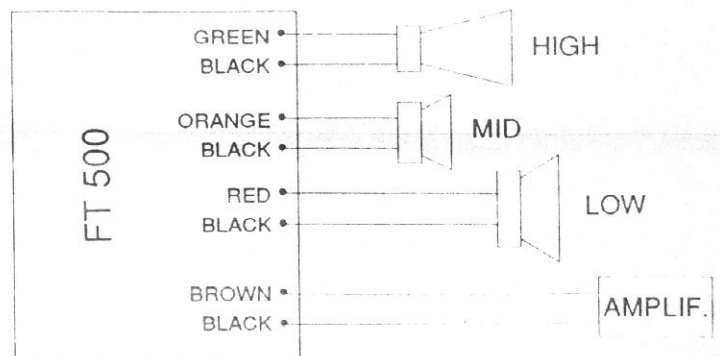

KIT 600

SPECIFICATIONS

FREQUENCY RESPONSE: 45 ÷ 20000 Hz

SENSITIVITY: 100 dB

POWER HANDLING:
600 W AES/300 W sine wave

MAXIMUM SPL: 128 dB

CROSSOVER FREQUENCY: 1200 Hz

IMPEDANCE: 8 Ohms

MAXIM. RECOMM. AMPLIF. POWER:
350 W

COMPONENTS: L.F. L15/554K
M.H.F. N580/H3709

CROSSOVER: FT 600

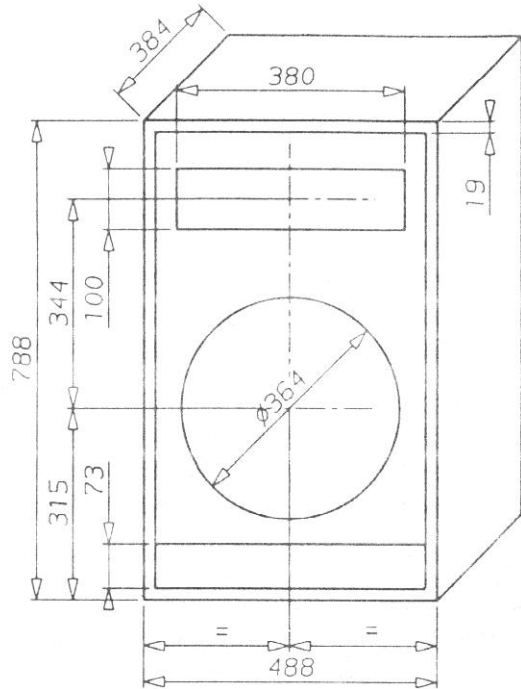

CONSTRUCTION NOTES

- Place glass fiber inside cabinet
- Use cross braces against vibrations

CROSSOVER CONNECTION

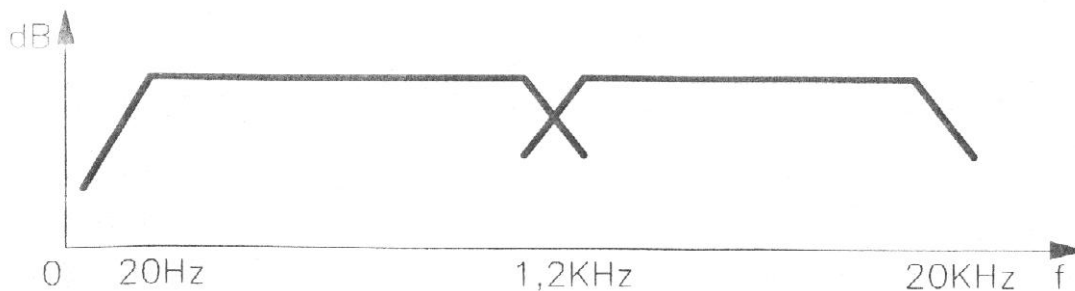
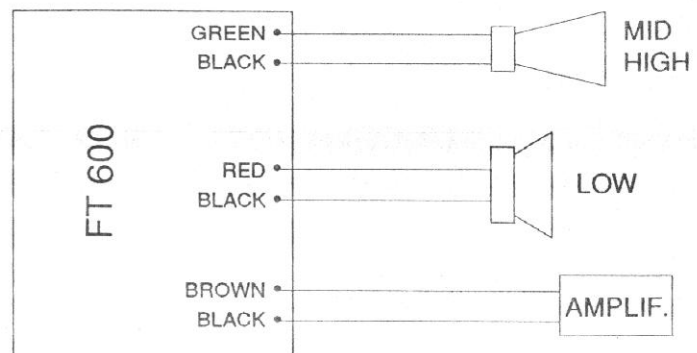

KIT 800

SPECIFICATIONS

FREQUENCY RESPONSE: 35 ÷ 19000 Hz

SENSITIVITY: 96 dB

POWER HANDLING:
800 W AES/400 W sine wave

MAXIMUM SPL: 125 dB

CROSSOVER FREQUENCY: 1200 Hz

IMPEDANCE: 8 Ohms

MAXIM. RECOMM. AMPLIF. POWER:
450 W

COMPONENTS: L.F. L15P200AK
M.H.F. N580/H3709

CROSSOVER: FT 800

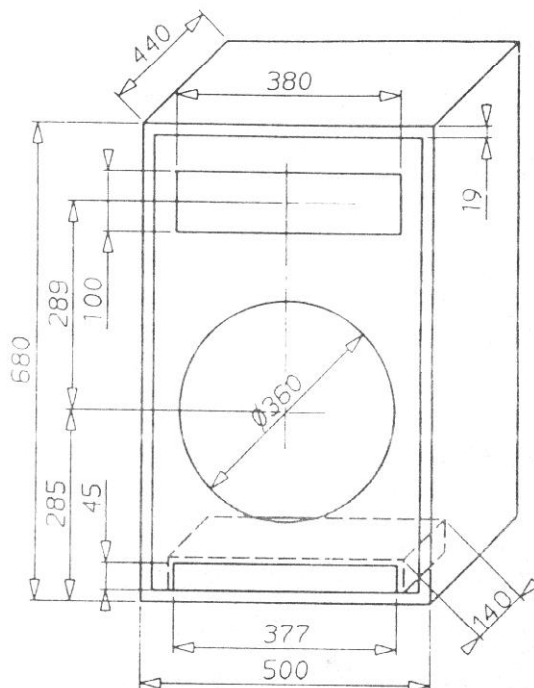

CONSTRUCTION NOTES

- Place glass fiber inside cabinet
- Use cross braces against vibrations

CROSSOVER CONNECTION

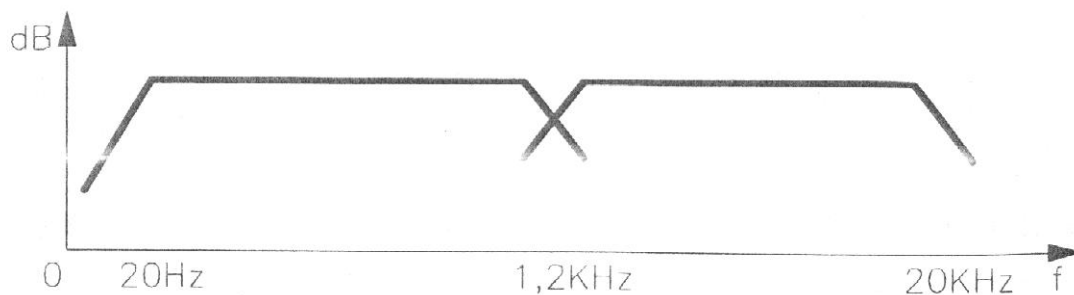
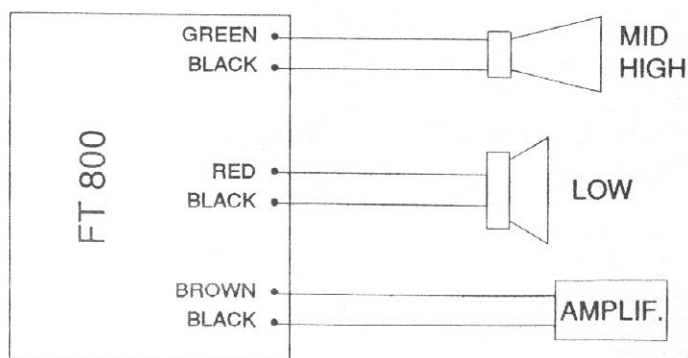

KIT 900

SPECIFICATIONS

FREQUENCY RESPONSE: 30 ÷ 20000 Hz

SENSITIVITY: 100 dB

POWER HANDLING:
900 W AES/450 W sine wave

MAXIMUM SPL: 130 dB

CROSSOVER FREQUENCIES:
400 ÷ 4000 Hz

IMPEDANCE: 8 Ohms

MAXIM. RECOMM. AMPLIF. POWER:
500 W

COMPONENTS: L.F. L18/651 or L 18P751
M.F. L10/581
H.F. N 481K/H3709

CROSSOVER: FT 900

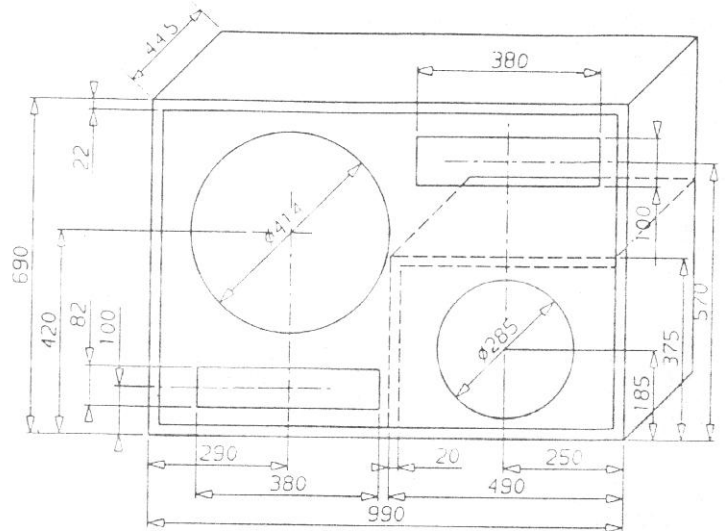

CONSTRUCTION NOTES

- Check airtightness of mid cabinet
- Place glass fiber inside cabinet
- Use cross braces against vibrations

CROSSOVER CONNECTION

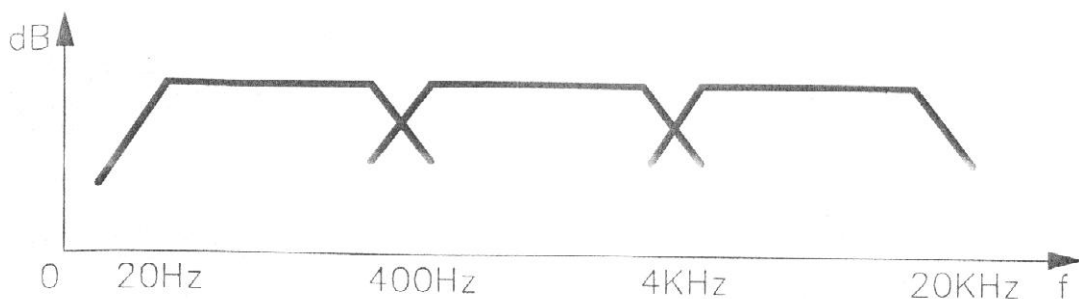
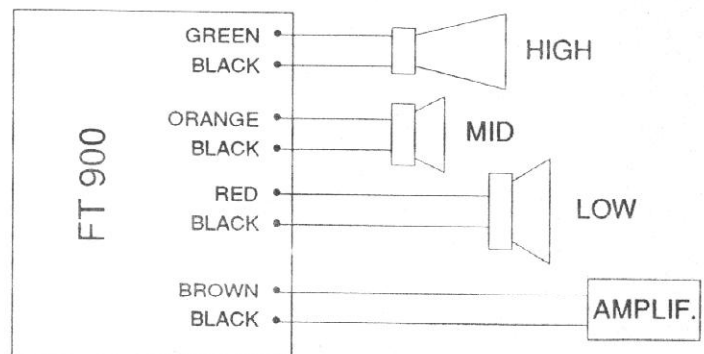

KIT 1000

SPECIFICATIONS

FREQUENCY RESPONSE: 30 ÷ 20000 Hz

SENSITIVITY: 103 dB

POWER HANDLING:
1000 W AES/500 W sine wave

MAXIMUM SPL: 130 dB

CROSSOVER FREQUENCIES:
500 ÷ 5000 Hz

NOMINAL IMPEDANCE: 8 Ohms

MAXIM. RECOMM. AMPLIF. POWER:
500 W

COMPONENTS: L.F. 2 X L15/542K
M.F. 1 L10/750YK
H.F. 1 N 481K/H2009

CROSSOVER: FT 1000

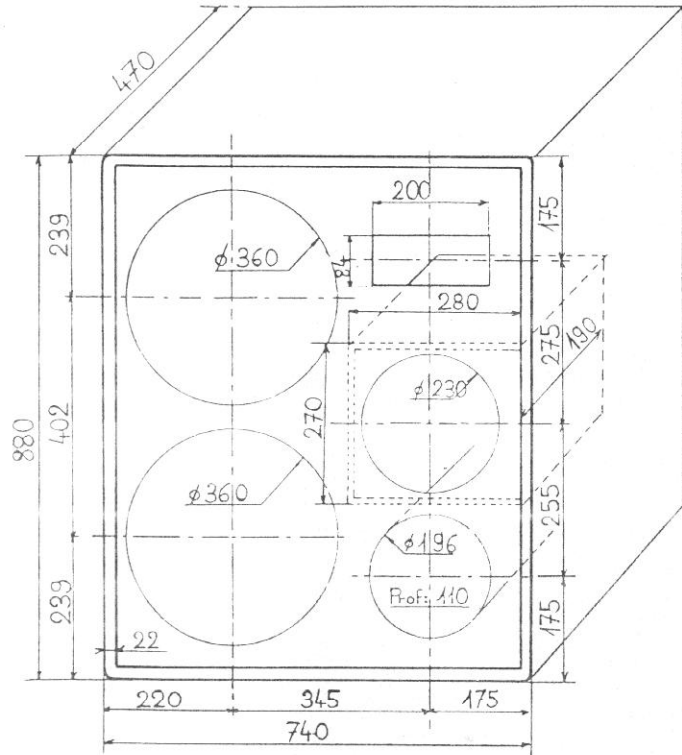

CONSTRUCTION NOTES

- Check airtightness of mid cabinet
- Place glass fiber inside cabinet
- Use cross braces against vibrations

CROSSOVER CONNECTION

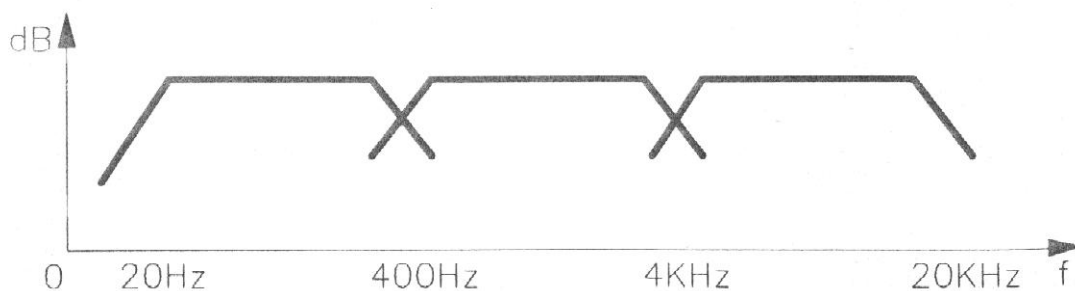
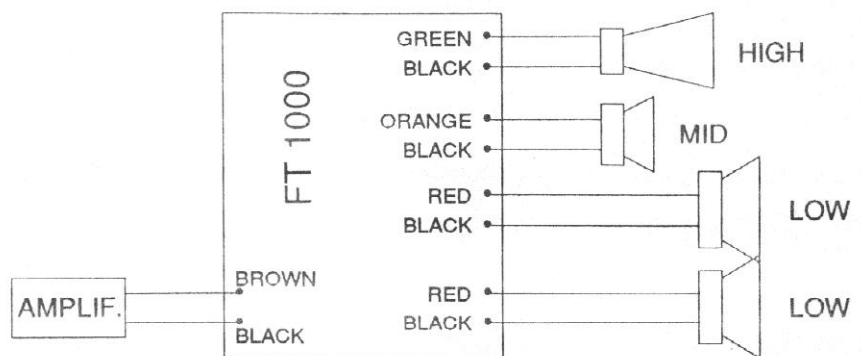

KIT 1200 SUBWOOFER

SPECIFICATIONS

FREQUENCY RESPONSE: 30 ÷ 300 Hz

SENSITIVITY: 99 dB

POWER HANDLING:
1200 W AES/600 W sine wave

MAXIMUM SPL: 130 dB

CROSSOVER FREQUENCY:
150 Hz

IMPEDANCE: 4 Ohms

MAXIM. RECOMM. AMPLIF. POWER:
800 W

COMPONENTS: L.F. 2 X L15P200AK

CROSSOVER: Electronic crossover

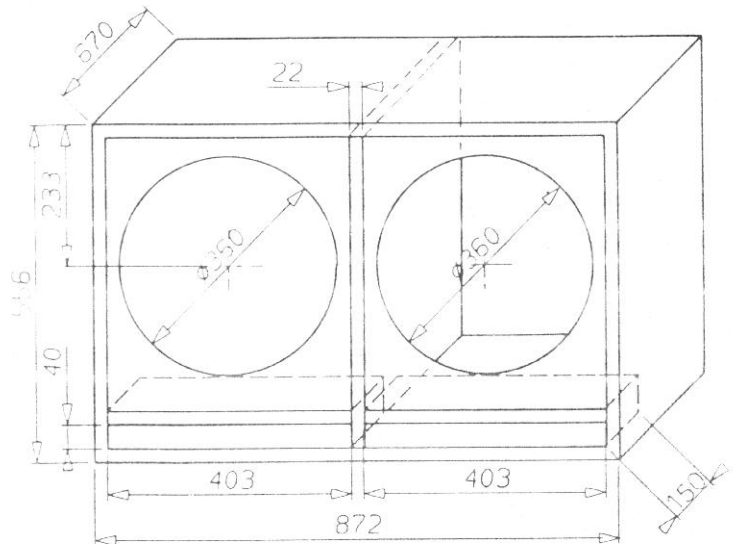

CONSTRUCTION NOTES

- Use cross braces against vibrations
- Walls thickness: 22 mm

CROSSOVER CONNECTION



Direct connection

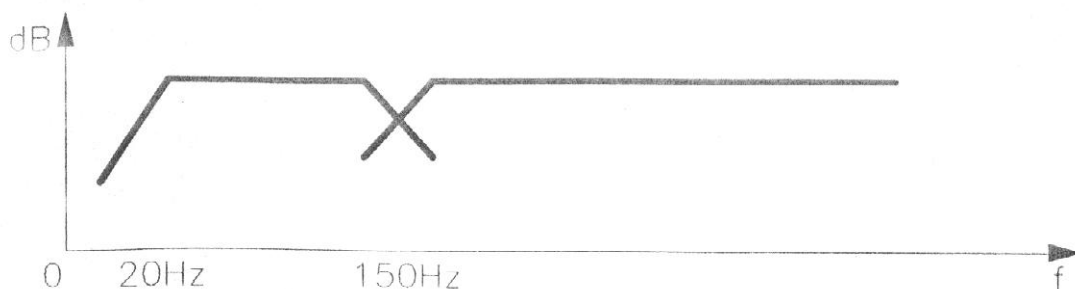

KIT 1300

MID HIGH CABINET

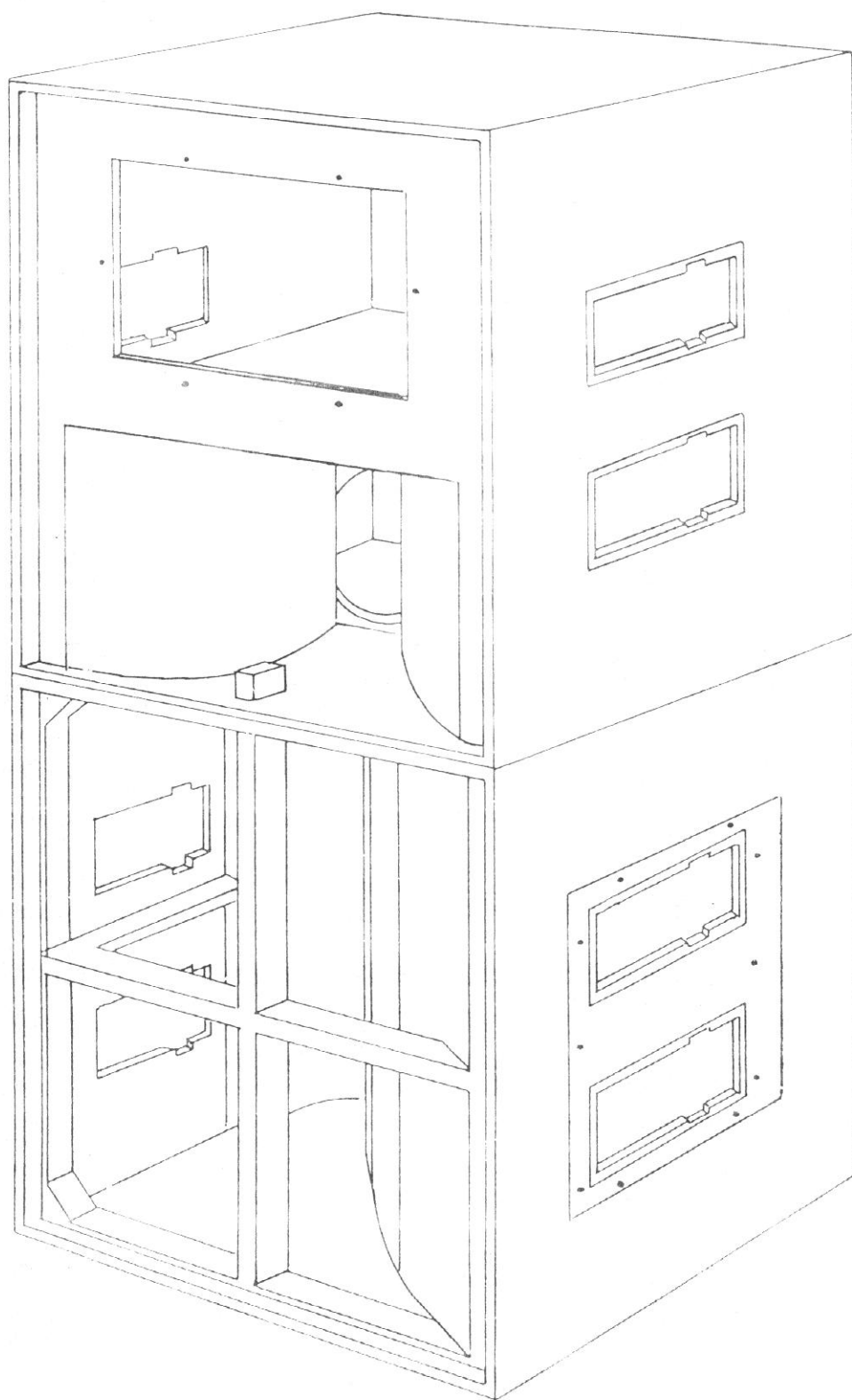

BASS CABINET

KIT 1300

SPECIFICATIONS

FREQUENCY RESPONSE: 45 ÷ 18000 Hz

COVERAGE ANGLE: Horizontal 90 degrees
Vertical 40 degrees

SENSITIVITY: 109 dB

POWER HANDLING:

1300 W AES/650 W sine wave
L.F. 800 W AES/400 W sine wave
M.F. 300 W AES/150 W sine wave
H.F. 250 W AES/100 W sine wave

MAXIMUM SPL: 138 dB

CROSSOVER FREQUENCIES: 35 Hz
250 Hz
1500 Hz

NOMINAL IMPEDANCE: L.F. 4 Ohms
M.F. 8 Ohms
H.F. 8 Ohms

COMPONENTS: L.F. 2 X L15/554K
M.F. 1 L12P11WK or L12P110K
H.F. 1 N 980/H9040

CROSSOVER: Electronic crossover
or FT 1300 Passive crossover

SPEAKER CABINET: 1 Cabinet Bass
1 Cabinet Mid High

The KIT 1300 design is a high definition loudspeaker system for high output reinforcement applications.

The mid and bass horn loaded designs make use of advanced mathematical models enabling to achieve exceptionally smooth air loaded impedance characteristics.

The extremely high sound pressure level and the linear frequency response anywhere in its coverage area are obtained in small dimensions.

These characteristics, which cannot be obtained with other designs make the KIT 1300 ideal for stage use, sound reinforcement, open air, large disco when wide coverage at high SPL is desired.

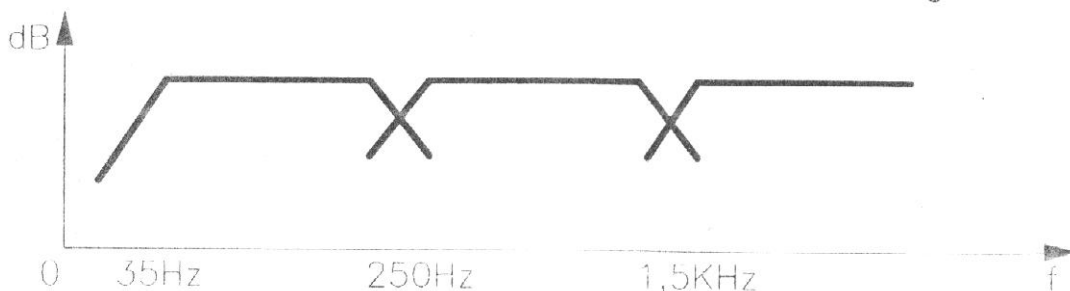
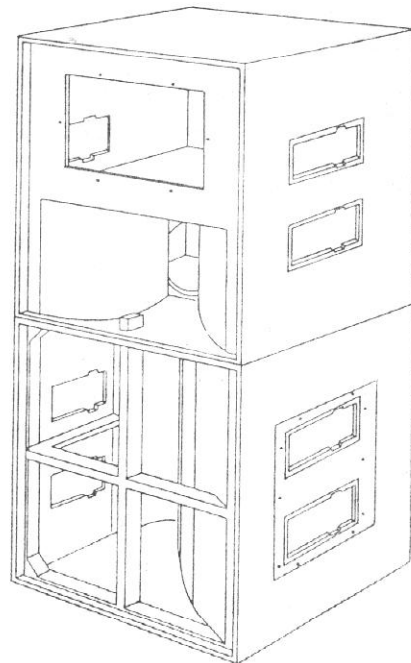

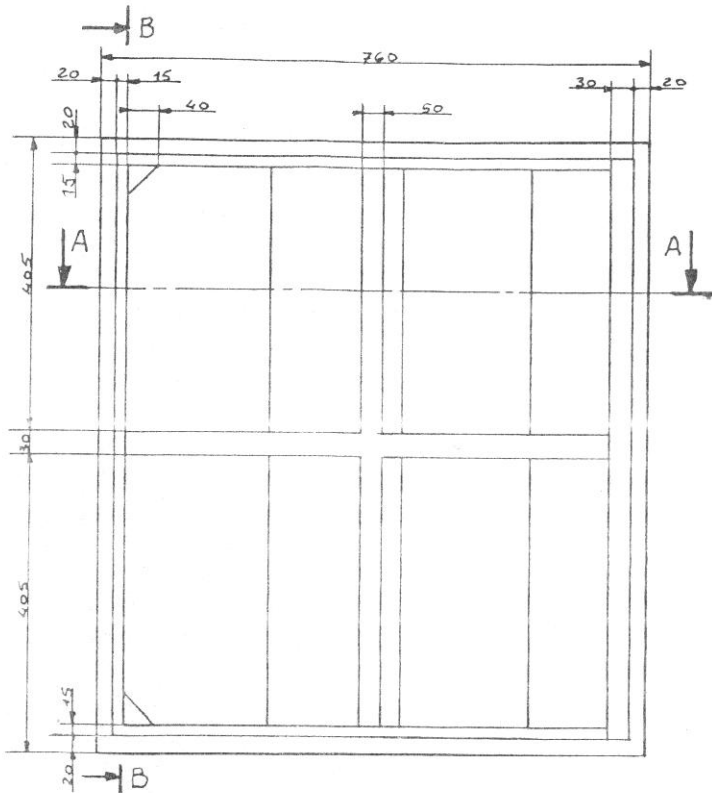

B B CROSS SECTION

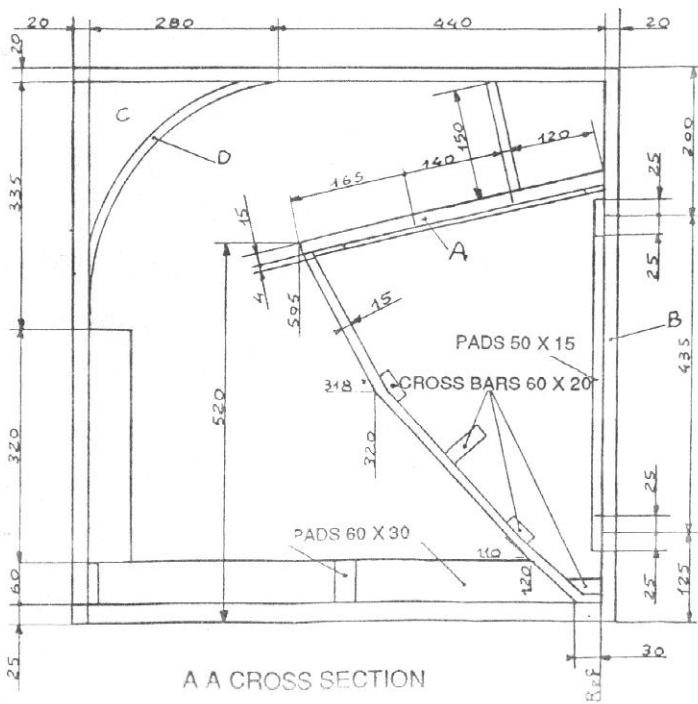
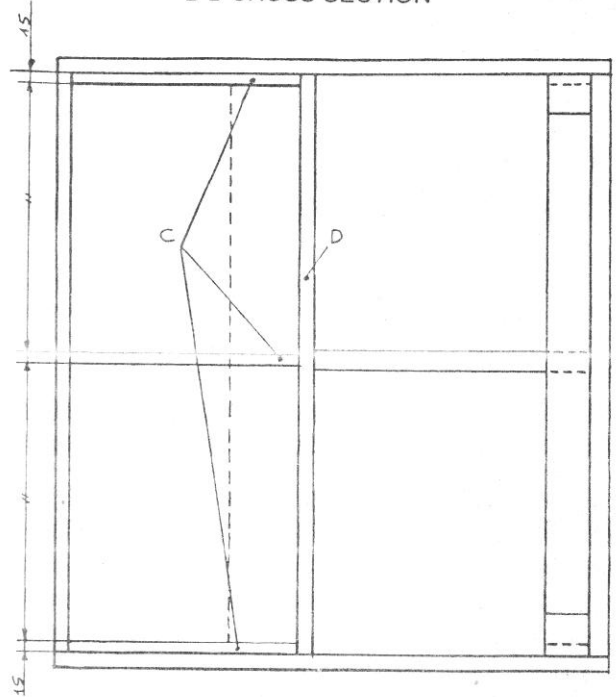

A A CROSS SECTION

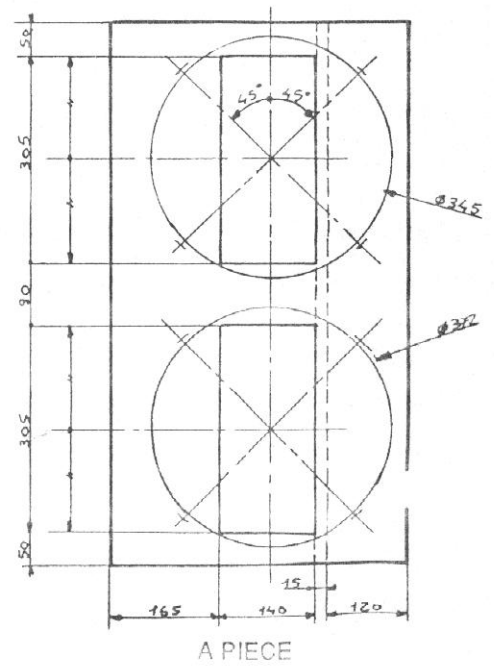

A PIECE

BASS CABINET

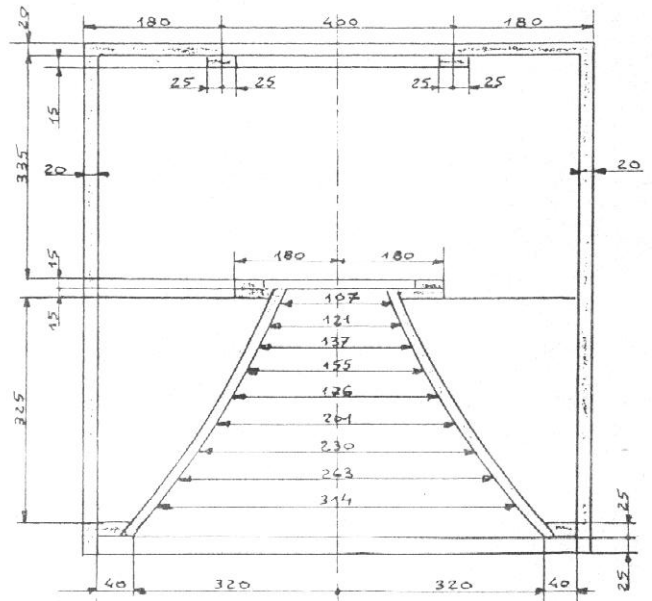
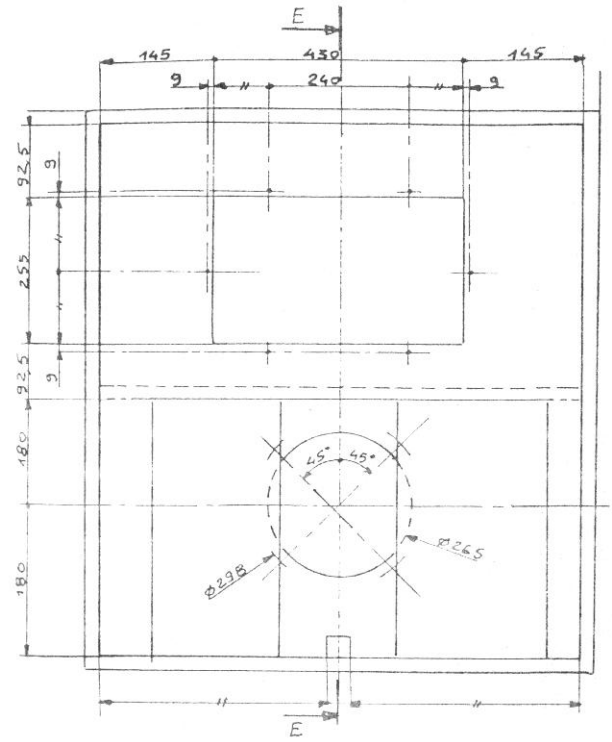
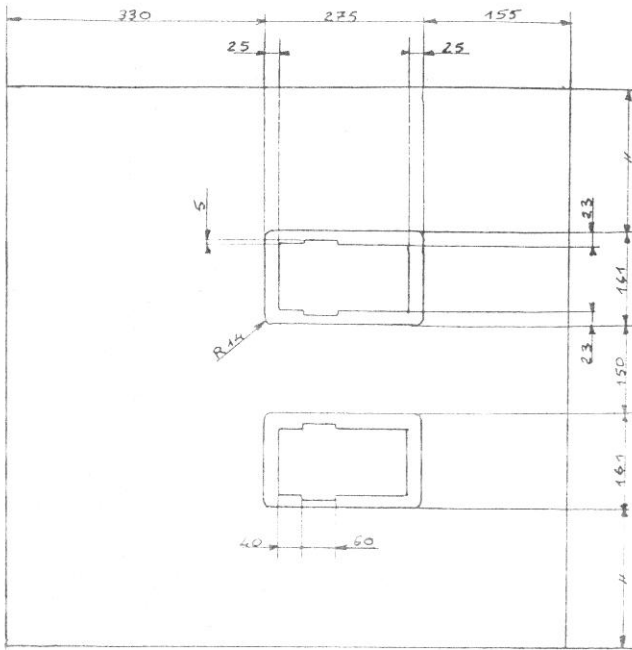

MID HIGH CABINET

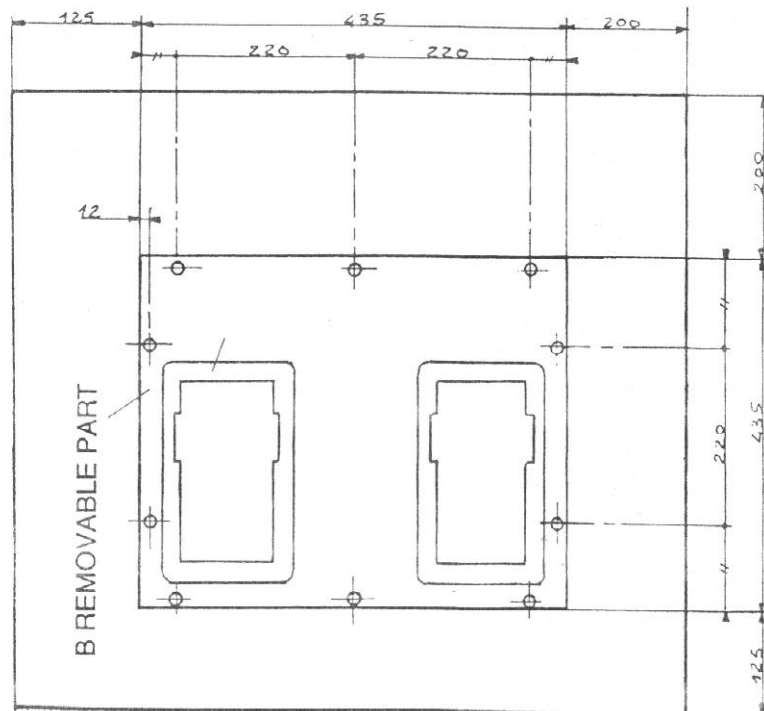
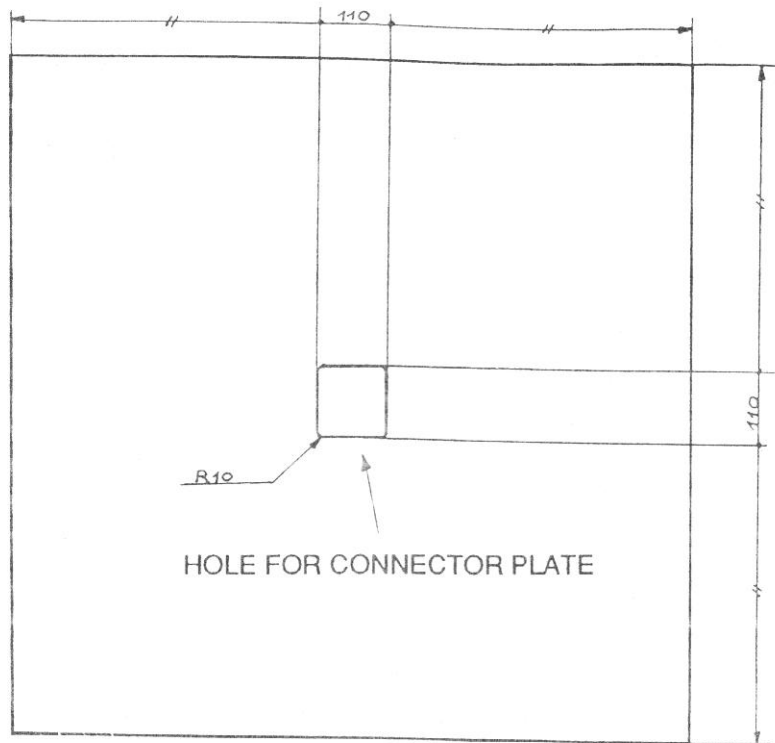

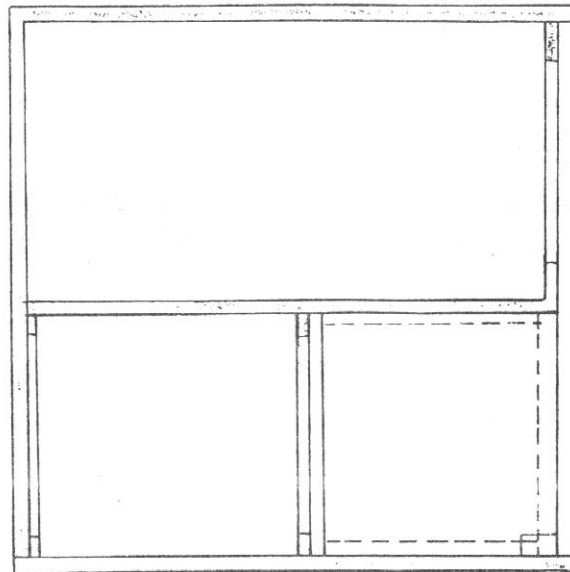
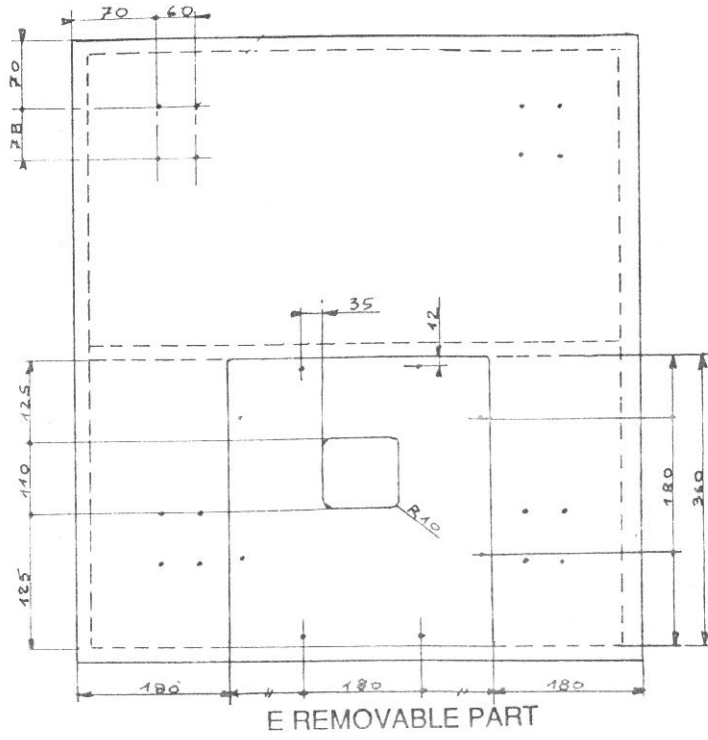

EE CROSS SECTION



RADIO CINE FORNITURE S.p.A.

Sede e Stabilimenti

42029 San Maurizio (Reggio Emilia)

Via G. Notari 1/A

Tel. (0522) 551840 (8 linee)

Ufficio Export Tel. (0522) 557680

Telex 531381 RCFRE-I

Telefax (0522) 551875